

## IDRO

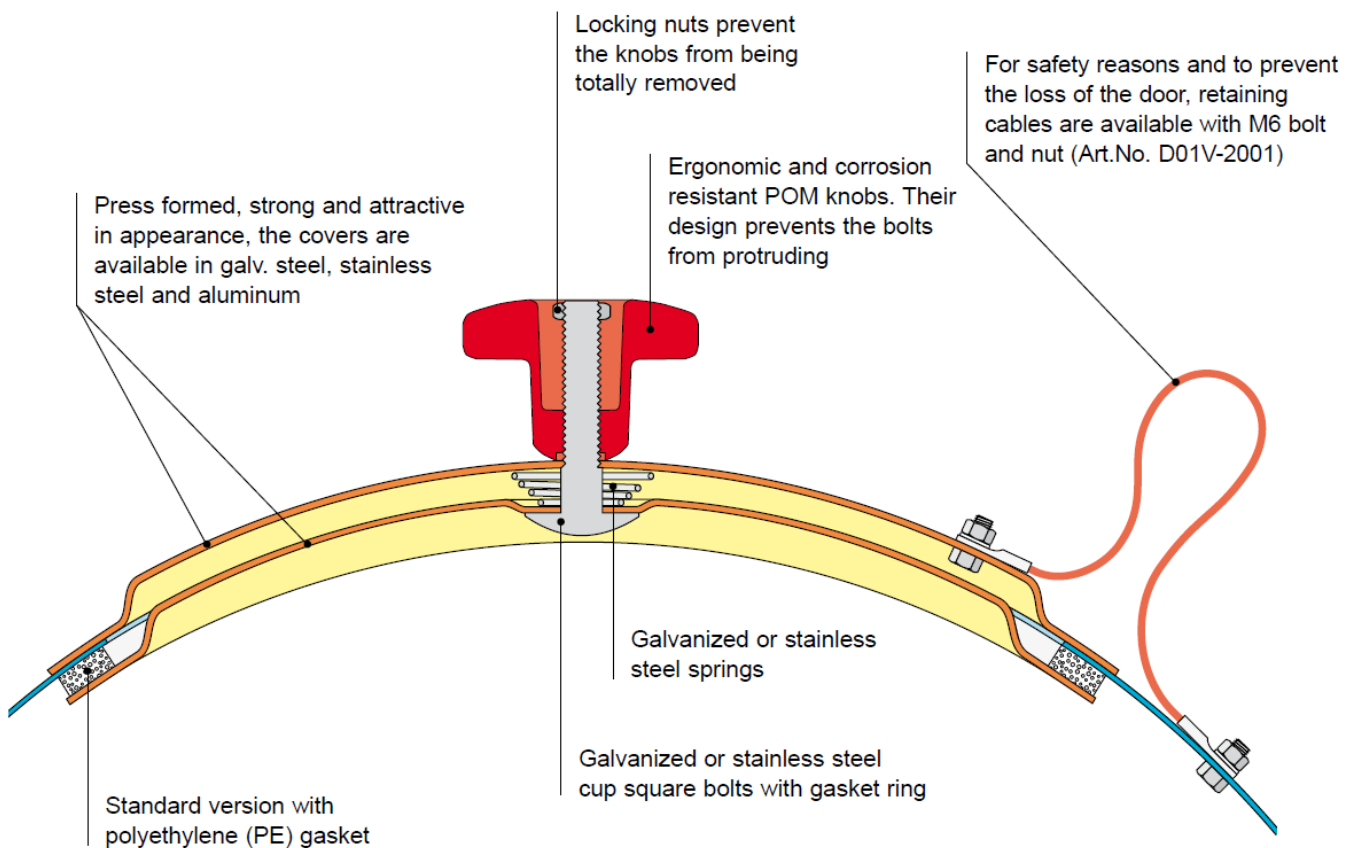

### Access Doors RRD

- For round ducts
- Available in five sizes  
180 x 80 mm  
200 x 100 mm  
300 x 200 mm  
400 x 300 mm  
500 x 400 mm
- For duct-Ø 68 to 1800 mm  
(not all opening dimensions)
- In galvanized steel, stainless steel and aluminum
- The duct wall is clamped between two stable covers
- Two knobs allow a comfortable handling and operation of the access door



## IDRO

### Standard Version:

#### With Polyethylene (PE) Gasket and POM Knobs

Operating Temperature: max. +70°C



Polyethylene specifications: Additional Information ZI-201  
Knobs specifications: Additional Information ZI-301  
Material specifications: Additional Information ZI-101

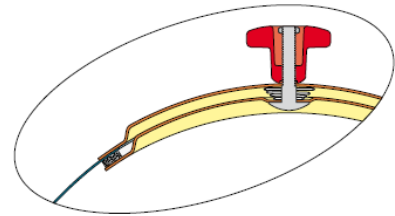

### Version with Self-Adhesive Rubber Edge Molding:

#### With Rubber Edge Molding (SKK) and POM knobs

Operating Temperature: max. +80°C



SKK specifications: Additional Information ZI-204

The self-adhesive rubber edge molding is wrapped along the edges of the duct opening, serves as gasket and prevents injuries.

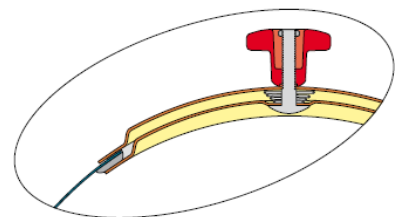

### Version for higher Temperatures:

#### With Vitreous Fibers (KF) Gasket and Metal knobs (HT)

Operating Temp.: Galv. steel version max. +200°C  
Stainless V2A version max. +300°C



Vitreous fibers specifications: Additional Information ZI-206  
Material specifications: Additional Information ZI-101

Notice: The glue holding the vitreous fibers might be destroyed above 200°C. We therefore recommend to replace the gasket after each opening of the access door.

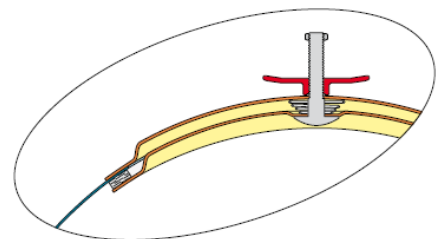

### Version for the Food Industry:

#### With Silicon Gasket and POM Knobs

Operating Temperature: max. +80°C



Silicon specifications: Additional Information ZI-211

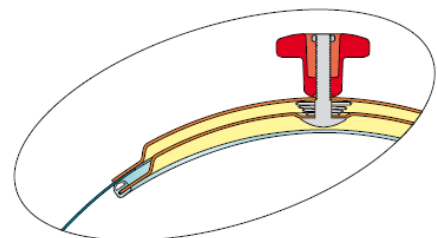

### Version for the Food Industry and higher Temperatures:

#### With Silicon Gasket and Metal Knobs (HT)

Operating Temperature: max. +200°C



Silicon specifications: Additional Information ZI-211

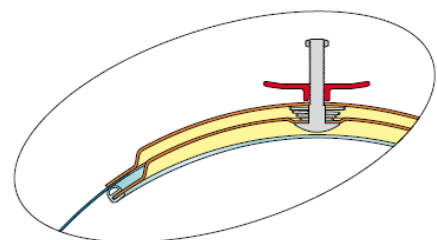

## IDRO

### RRD Opening Dimensions According to Duct Diameters

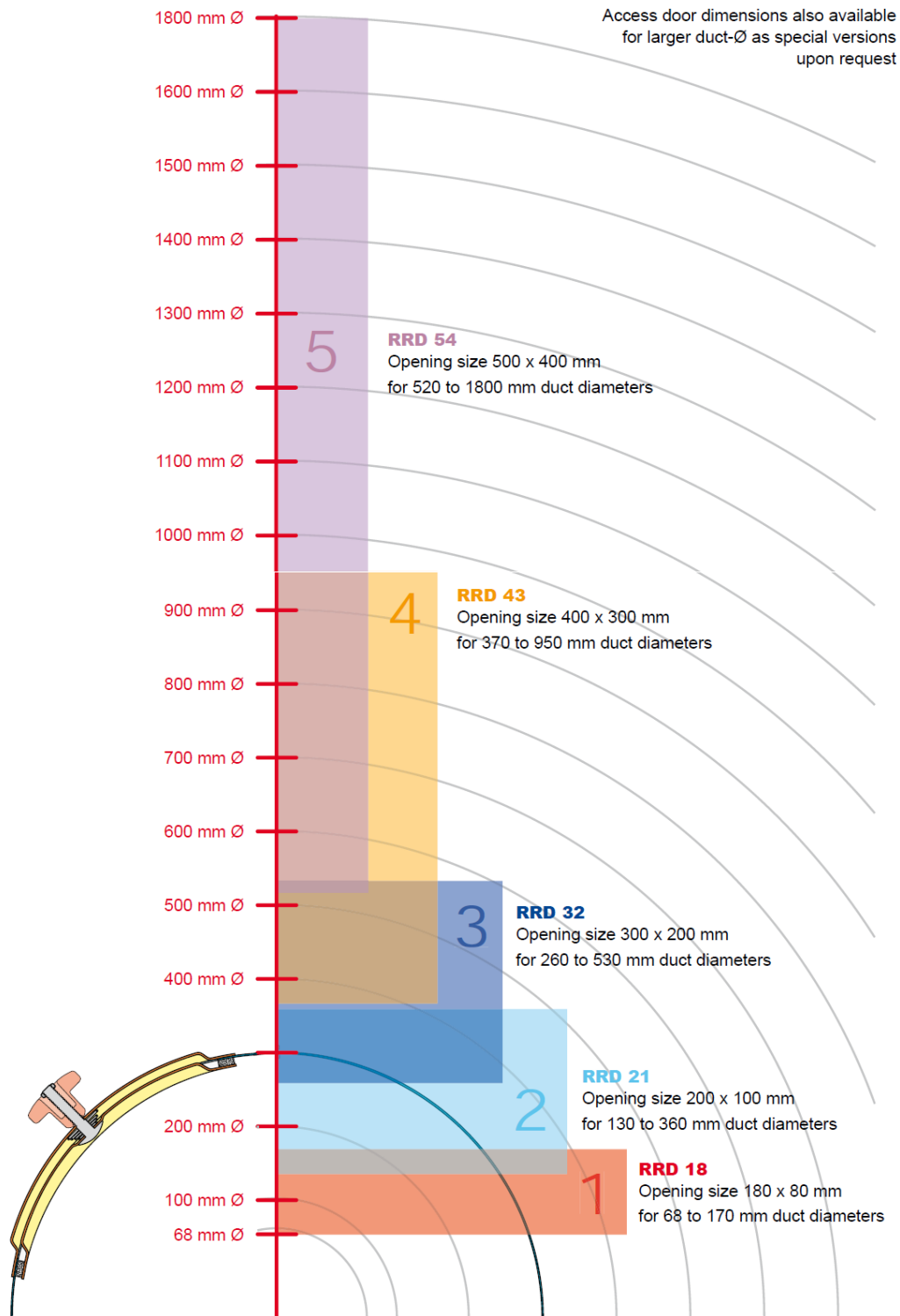

## IDRO

### Installation Instructions

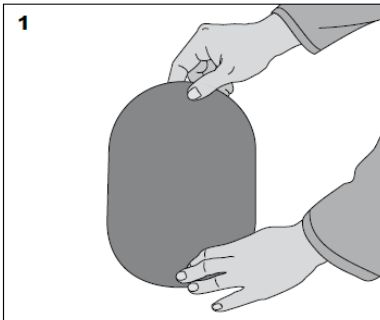

1 Apply the self-adhesive template on the duct wall at the desired position

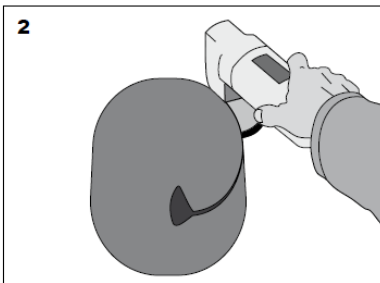

2 Cut the opening following the edge of the template

For access doors ordered with SKK rubber edge molding:

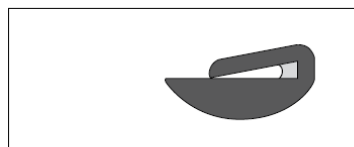

The SKK molding is fitted with injected glue. It can be applied on duct walls up to 2 mm thick (Gauge ≈14)

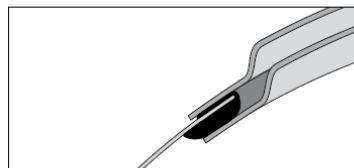

The thicker lip of the SKK must be inside the duct

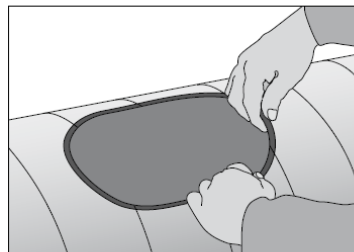

Apply the SKK molding so that the duct wall enters as deeply as possible into the pocket. Both ends should meet at a straight section, pressing slightly against each other but without overlapping. To cut the insulation properly we recommend the use of the Original Loewe Scissors (Art. No. G04V-1005)

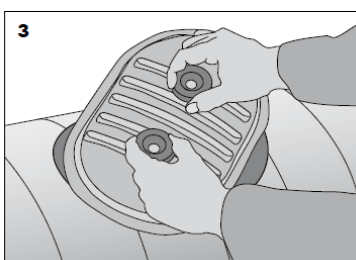

3 Turn the knobs till they hit the stops and insert the inner door panel inside the opening at an angle.

Then straighten the door, pull it lightly to center it and tighten the knobs.